

W16-102
 18" X 18"
 RED W/9 - 3" DIA. OR HIGH INTENSITY RED
 REFLECTORIZED FACE 18" x 18".
 RED REFLECTORS

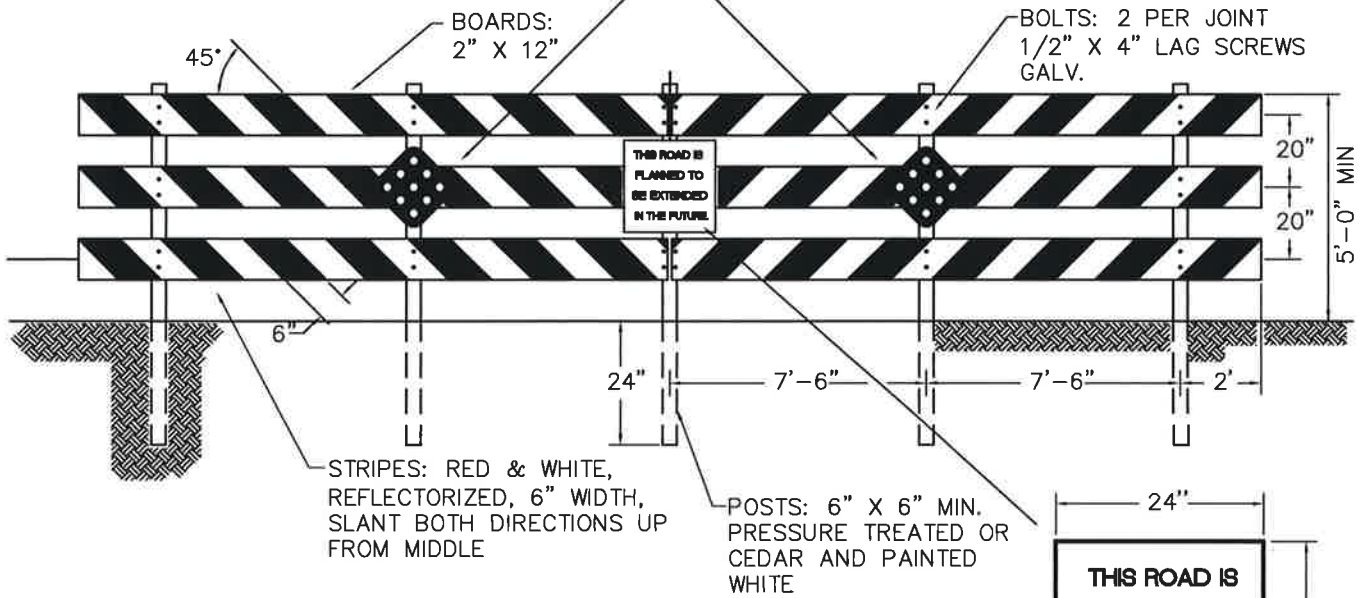

STRIPES: RED & WHITE,
 REFLECTORIZED, 6" WIDTH,
 SLANT BOTH DIRECTIONS UP
 FROM MIDDLE

POSTS: 6" X 6" MIN.
 PRESSURE TREATED OR
 CEDAR AND PAINTED
 WHITE

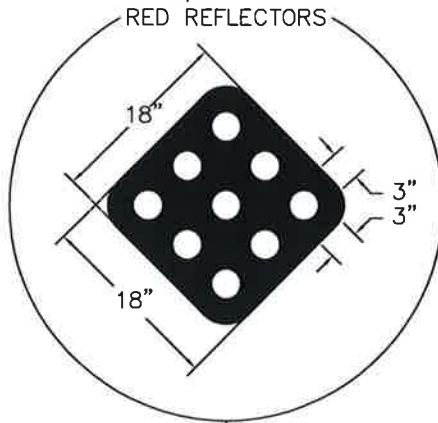
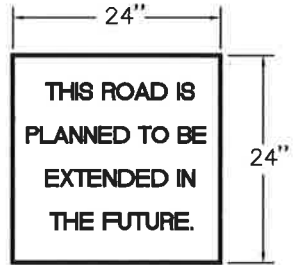

NOTES:

1. THIS IS NOT A CONSTRUCTION BARRICADE.
2. THE WORDS "THIS ROAD IS PLANNED TO BE EXTENDED IN THE FUTURE" SHALL BE STENCILED IN 6 INCH WHITE LETTERS ON PAVEMENT APPROXIMATELY 10 FEET FROM BARRICADE.

Approved: *[Signature]* March 16, 2018
 City Engineer Date

STREET STANDARD DETAIL



Dwg No: **S13**
BARRICADE