



"The City of Bonney Lake's mission is to protect the community's livable identity and scenic beauty through responsible growth planning and by providing accountable, accessible and efficient local government services"

FOR STAFF USE ONLY	
Date:	_____
Expiration Date:	_____
Permit Number:	_____

ROAD APPROACH/RIGHT OF WAY APPLICATION

Application and Plans must be complete in order to be deemed accepted.
All Permit Applications must be made "in person" at the Permit Center. Please circle who is to be billed for this permit.

A CERTIFICATE OF INSURANCE AND BOND MUST BE INCLUDED WITH THIS APPLICATION		
Circle One: Right of Way Temporary Road Approach Access Permanent Road Approach Access		
Project Name / Description:		Tax Parcel Number
Site Address:		Lot Number:
General Location:		Block:
Site Information:		Subdivision:
Section: _____	Township: _____	Range: _____ 1/4: _____ 1/4- _____
Applicant:		Phone:
Street Address: _____ City _____		Fax #:
State/Zip _____		
Property Owner:		Phone:
Street Address: _____ City _____		Fax #:
State/Zip _____		
Contractor:		Phone:
Street Address: _____ City _____		Fax #:
State/Zip _____		
State Contractor's License #: _____		City of Bonney Lake Business Registration:
Date: _____ Expiration _____		
Description & Date of Project _____		
Insurance Information:		Policy Number:
Insurance Company: _____		
Bond Information:		

Requirements and Conditions:

- **A working drawing or plan showing work to be done shall be submitted and dimensioned to the right of way lines. (All working drawings or plans are subject to approval from the Public Works Director.)**
- **Provide the City with a Certificate of Insurance in the amount of \$1,000,000.00 with the City of Bonney Lake as the additional name insured and a Street Restoration Bond in the amount of \$5,000.00.**
- All trenches shall have a backfill of not less than 36 inches (depth to the top of the line or pipe) and sufficient compaction so the finished surface conforms with the original surface. All trenches across driveways shall be backfilled and compacted according to the State Standard Specifications unless a variance is approved by the Public Works Director.
- **No pavement cuts** across streets, roads, or driveways constructed of asphalt concrete or Portland cement, unless approval has been granted by the Public Works Director for such crossing, and all pavement cuts shall be made by sawing.
- Backfill of trenches across driveways or roadways shall be mechanically tamped in layers not more than 6 inches in depth. Trenches shall be backfilled with gravel base if material removed is not suitable for replacement. Excess excavated material shall be disposed of by applicant.
- Property owners and/or residents along this project shall have the right of safe egress at all times.
- At no time during construction will any roadway be entirely closed. One way traffic shall be maintained at all times unless an approved, signed detour route is established. All traffic control shall comply with the M.U.T.C.D.
- Crushed rock shall be placed on the shoulder of the roadway as directed by the Public Works Director.
- A temporary patch of cold mix asphalt shall be placed and maintained on road crossings and driveways by the applicant after backfilling until a permanent patch can be placed.
- Permanent patching shall be done by the permittee.
- Any underground work shall require notification by the applicant to prevent damage to underground installations such as Gas, Power, Telephone, Cable, T.V., Water, and Sewer.
- No work in the Right of Way shall be done under this permit until the party or parties to whom it is granted shall Have communicated with and received instruction from Public Works Maintenance and Operations (253-862-8602 x-302).

I agree to comply with all City ordinances and design standards, State laws, and lawful orders of the inspector. I further agree to reimburse the City for any charges incurred from outside agencies (State, County, etc.). Pertinent and frequently requested standard details are attached for your convenience. For additional information, please see the current Development Policies and Public Works design standards at www.ci.bonney-lake.wa.us/administrative/public_works/ or at the City Hall Annex building located at 8720 184th Avenue East, Bonney Lake, WA 98391.

By leaving the contractor section blank, I hereby certify that I am the owner, or agent of the owner, of the subject property and contractors will not be hired to perform any work in association with this permit. I acknowledge that in leaving the contractor section blank, I do not intend to perform work for selling purposes without being a registered contractor by the State of Washington (RCW 18.27.090). I also verify that if I do choose to hire a contractor, general or subcontractor, I will only hire those which are licensed by the State of Washington (RCW 18.27.110).

Submitted by: _____ **Date:** _____

Signature: _____ **Phone:** _____

Authorizing Signature from Public Works

Date:



BOND NO. _____

STREET RESTORATION BOND

KNOW ALL MEN BY THESE PRESENT, That we _____

_____ as Principal, and the _____ with its principal office in Washington, As Surety, are held and firmly bound unto the City of Bonney Lake, hereinafter called Obligee, in the penal sum of Five Thousand and 00/100***** (\$5,000.00) Dollars for the payment of which well and truly to be made we do hereby bind ourselves, our heirs, executors, administrators, successors and assigns, jointly and severally, firmly by these presence.

SIGNED AND SEALED THE _____ DAY OF _____, _____.

WHEREAS, the said Obligee has granted or is about to grant to the said Principal; a License or Permit to open cut a utility trench within the Public right-of-way.

NOW, THEREFORE, if said Principal shall indemnify the Obligee against any loss directly arising by reason of the failure to comply with the law and ordinances governing the installation of utilities within said City of Bonney Lake then this obligation shall be void, otherwise to be and remain in full force and effect.

REGARDLESS of the length of time this bond shall continue to be in effect the aggregate liability of the Surety hereunder shall in no event exceed the amount of the bond.

PROVIDED, HOWEVER, that the Surety shall have the right to terminate its liability hereunder by serving written notice upon the Obligee the ten (10) days in advance of its intention to do so.

TERM OF BOND: _____ to _____.

PRINCIPAL

SURETY

by _____

by _____

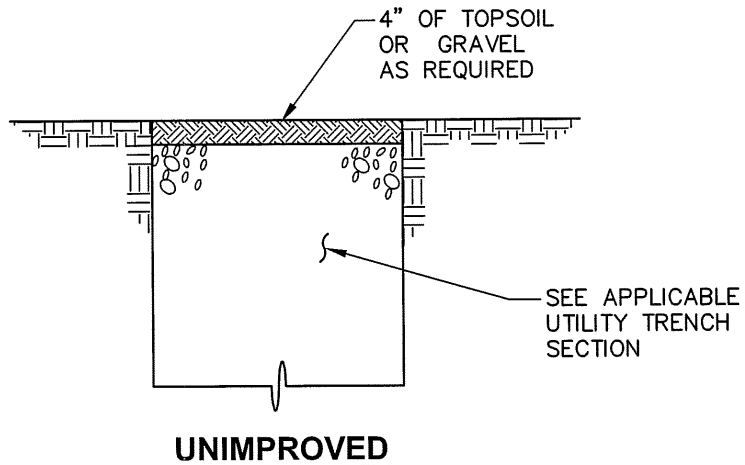
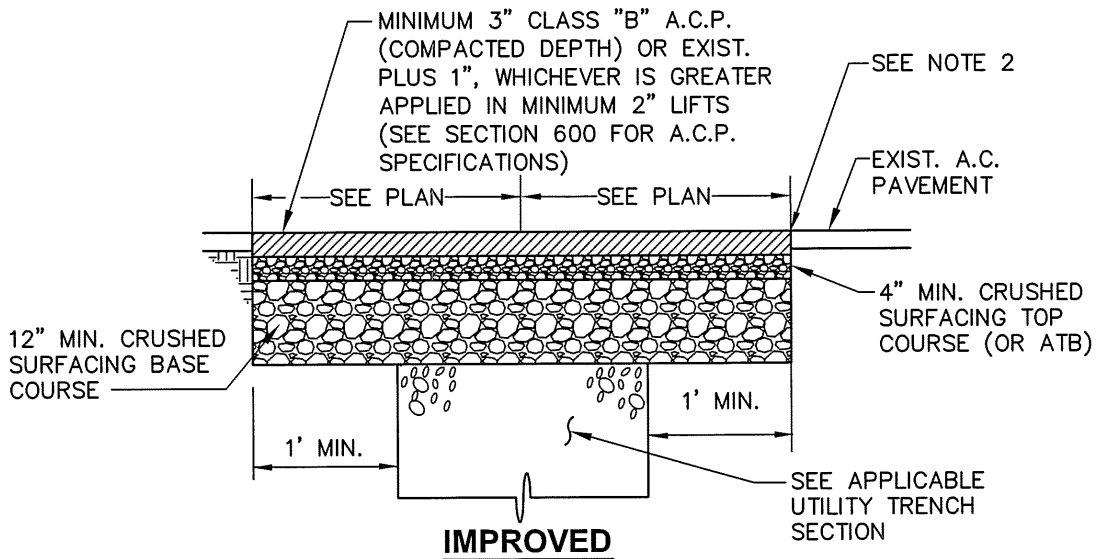

NOTES:

1. ALL MATERIALS EXCEPT ASPHALT CONCRETE SHALL BE COMPACTED IN 6-INCH MAXIMUM LIFTS TO 95% MAXIMUM DRY DENSITY.
2. ALL JOINTS SHALL BE SAW-CUT, JOINTS SHALL BE TACK COATED WITH EMULSIFIED ASPHALT GRADE CSS-1. TACK SHALL BE APPLIED TO EDGES OF EXISTING PAVEMENT. ALL JOINTS SHALL BE SEALED WITH PAVING ASPHALT AR4000W.
3. THE CITY INSPECTOR SHALL DETERMINE THE ACTUAL LIMITS FOR PATCHING AND OVERLAYS REQUIRED FOR PAVEMENT RESTORATION. JOINTS SHALL BE LOCATED AT THE EDGE OF TRAVEL LANES OR IN THE CENTER OF TRAVEL LANES AS DIRECTED BY THE CITY.
4. MINIMUM PAVEMENT REMOVAL WILL BE TO CENTERLINE.

Approved:

City Engineer

STREET STANDARD DETAIL

7-11-06
Date



Dwg No:

S6

**TRENCH
PAVEMENT RESTORATION**

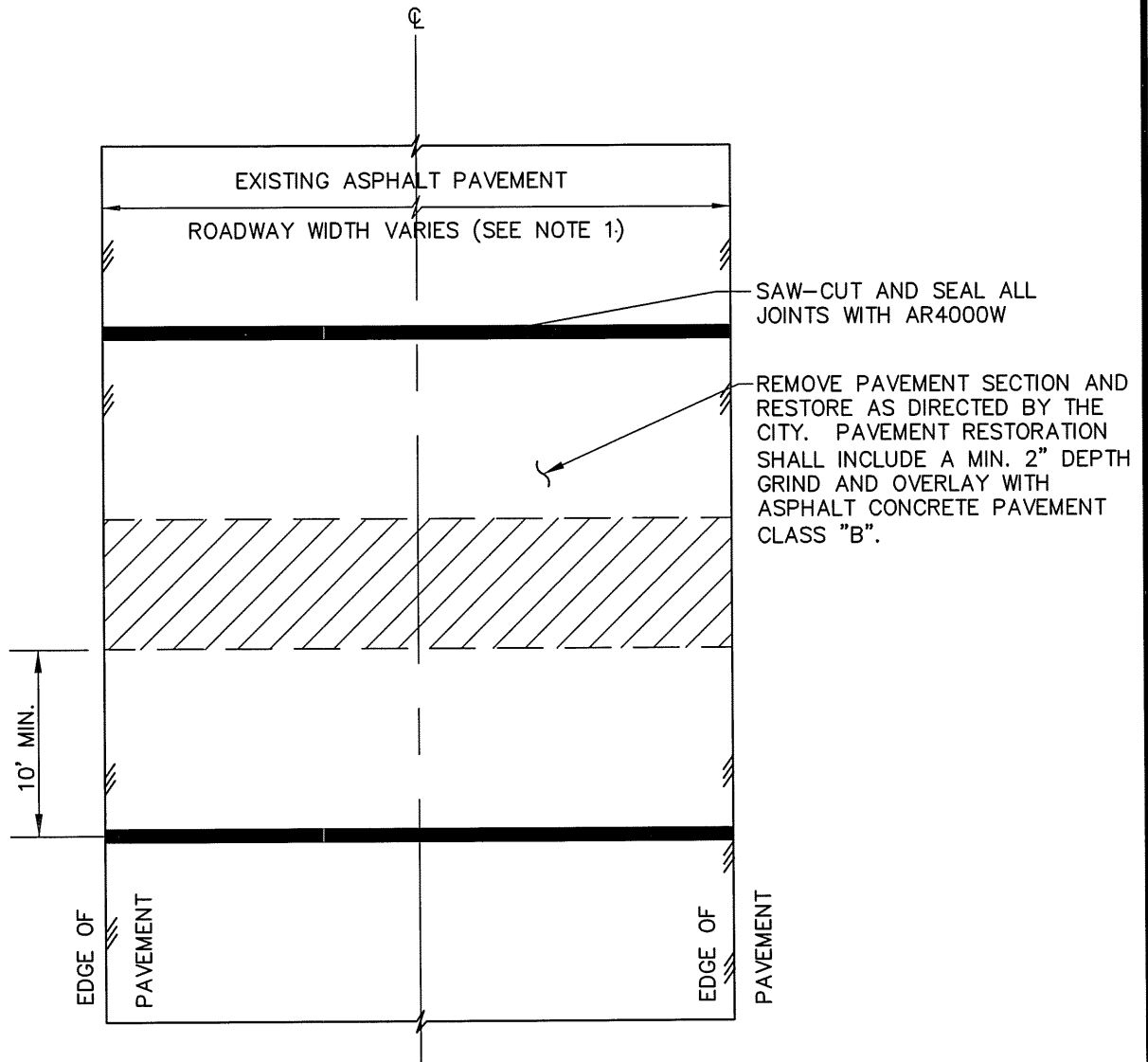

NOTES:

1. ALL ASPHALT PATCHES SHALL BE TO THE WIDTHS AS SPECIFIED BY THE CITY'S INSPECTOR.
2. IN CASES WHERE MULTIPLE CUTS (PERPENDICULAR TO THE DIRECTION OF TRAVEL) ARE MADE IN THE SAME ROAD WITHIN 200 FEET OR IN CASES WHERE A CUT IS MADE WITHIN 100 FEET OF AN EXISTING TRENCH RESTORATION, THE PAVEMENT (WIDTH AS SPECIFIED BY THE CITY) BETWEEN THE CUTS SHALL BE GROUND (2" MIN. DEPTH) AND OVERLAID AS DIRECTED BY THE CITY.
3. IN CASES WHERE CUTS ARE MADE IN THE DIRECTION OF TRAVEL, THE PAVEMENT SHALL BE GROUND (2" MIN. DEPTH) AND OVERLAID TO THE WIDTHS AS SPECIFIED BY THE CITY FOR THE ENTIRE LENGTH OF THE TRENCH.

Approved: _____

City Engineer

7.14.06
Date

STREET STANDARD DETAIL



Dwg No:

S6

**TRENCH
PAVEMENT RESTORATION**

6" MIN. CEMENT CONCRETE
CLASS 3000

6"X6" STEEL MESH
SUPPORTED ON 1" CHAIRS

MATCH EXISTING
DRIVEWAY GRADE

5 1/2"
1/2"

2% MAX.

BASE COURSE, SEE S11
TYPICAL SECTION DETAIL

4" CRUSHED SURFACING
TOP COURSE

BACK OF
PROPERTY
LINE
SIDEWALK

SECTION A-A

WIDTH VARIES FOR
RESIDENTIAL OR
COMMERCIAL

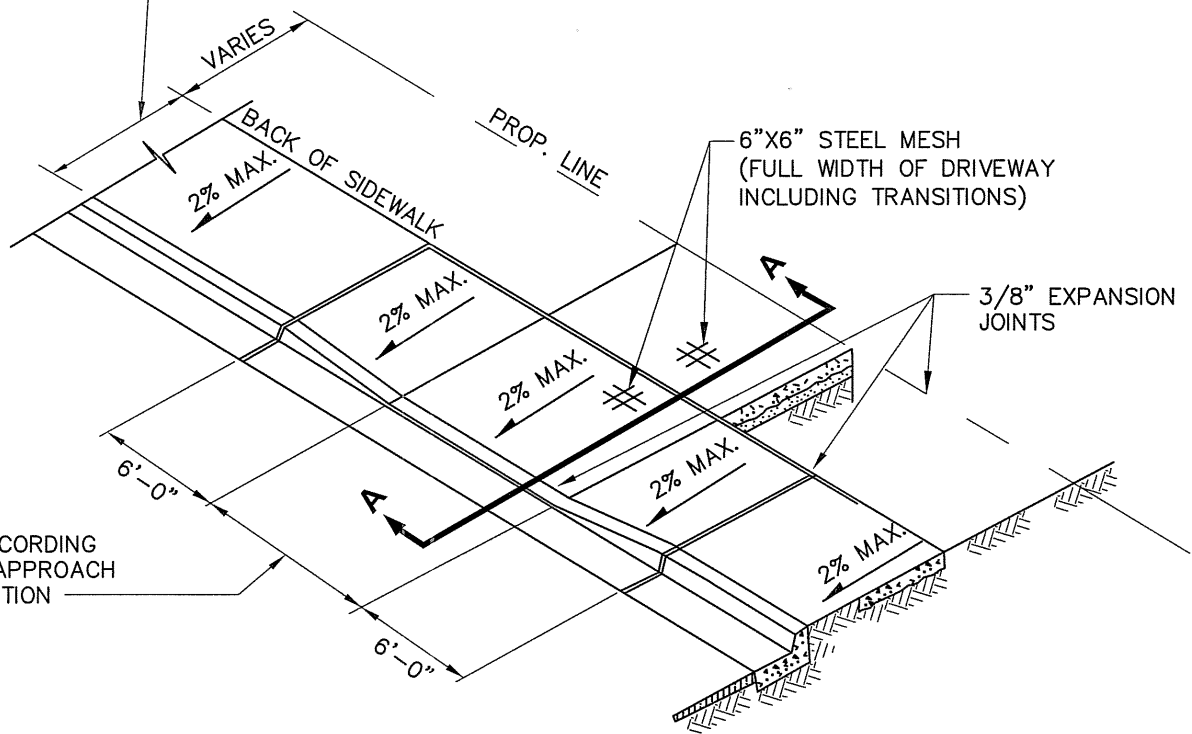

NOTES:

1. UNLESS OTHERWISE APPROVED, A MINIMUM OF 4 FEET OF FULL HEIGHT CURB IS REQUIRED BETWEEN TAPER SECTIONS OF DRIVEWAYS.

Approved:

City Engineer

Date

STREET STANDARD DETAIL

City of
BONNEY
Lake

Dwg No:

S9

**CEMENT CONCRETE
DRIVEWAY**

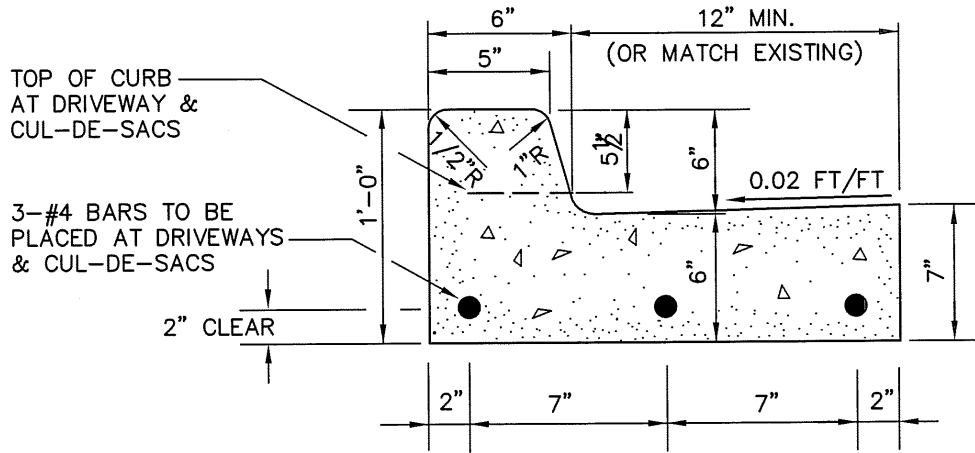

Approved:

City Engineer

STREET STANDARD DETAIL

6.17.05
Date

City of
BONNEY
Lake

Dwg No:

S10

**CONCRETE CURB
AND GUTTER**

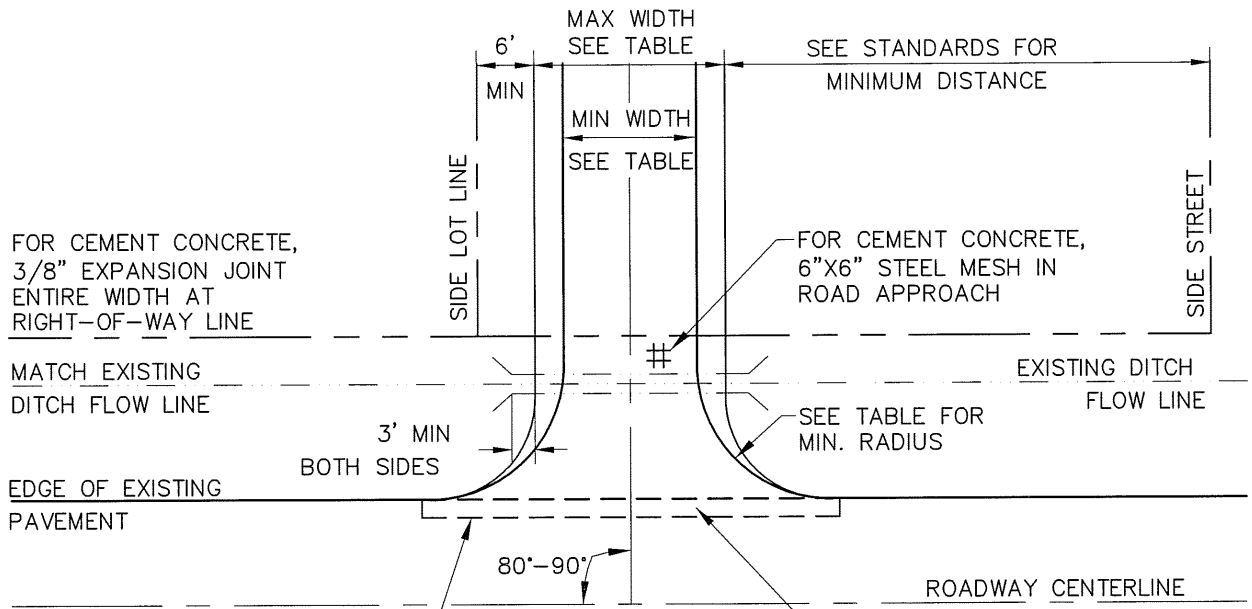

PLAN VIEW

FOR CEMENT CONCRETE, 3/8" EXPANSION JOINT ENTIRE WIDTH AT RIGHT-OF-WAY LINE

FOR CEMENT CONCRETE, 6"X6" STEEL MESH IN ROAD APPROACH

3' MIN BOTH SIDES

80°-90°

SAWCUT EXISTING PAVEMENT (MIN. 2' OFF EX. EDGE OR AS DIRECTED BY THE CITY)

RESTORE EXISTING PAVEMENT WITH 3" MIN. CL. B A.C.P. OVER 6" CSBC OR MATCH EXISTING PAVEMENT SECTION, WHICHEVER IS GREATER. CLEAN AND TACK EDGES WITH SEALER CSS1 AND SEAL JOINTS WITH HOT ASPHALT CEMENT AR4000W.

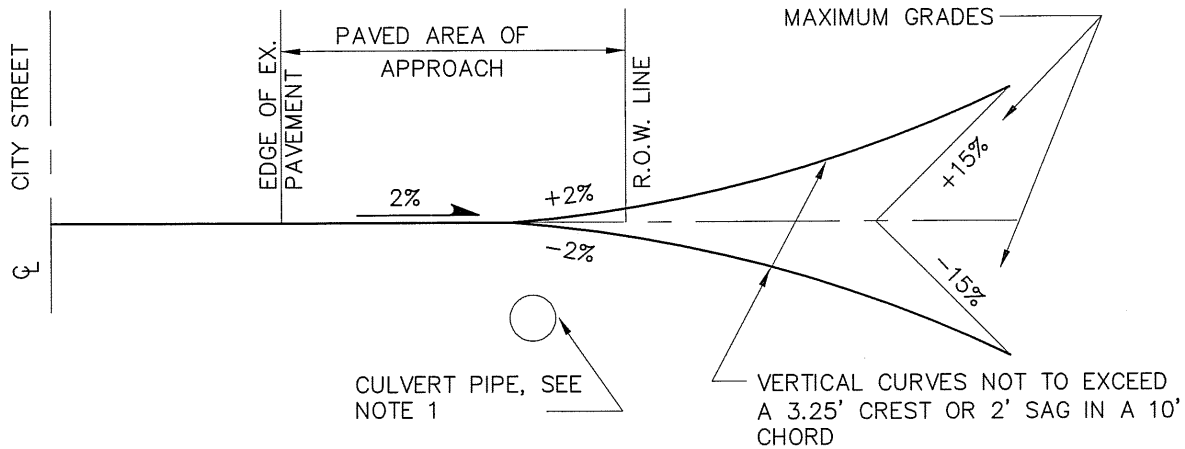

PROFILE VIEW

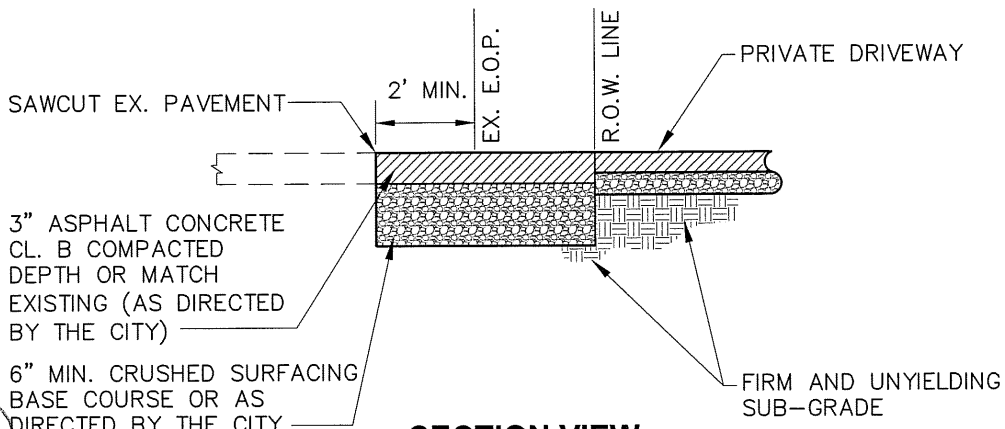

SECTION VIEW

Approved:

City Engineer

STREET STANDARD DETAIL

2-14-06
Date



Dwg No:

S11
ROAD APPROACH

RESIDENTIAL ROAD APPROACH

DESIGN ELEMENT	MAJOR ROAD APPROACH	MINOR ROAD APPROACH	RES. ROAD APPROACH
MIN. APPROACH RADIUS	AS APPROVED	25'	10'
MIN. APPROACH WIDTH	24 FEET (15 FEET FOR ONE WAY)	24'	15'
MAX. APPROACH WIDTH	30'	30'	25'

NOTES:

1. CULVERT PIPE SHALL BE CONCRETE OR SMOOTH WALL HDPE WITH LOCKING JOINTS AND H20 TRAFFIC RATING. PIPE WITH LESS THAN 12" OF COVER SHALL BE DUCTILE IRON PIPE CLASS 50 OR CONCRETE CLASS V.
2. STORMWATER RUNOFF FROM THE PUBLIC RIGHT OF WAY SHALL NOT BE PERMITTED TO DRAIN ONTO PRIVATE PROPERTY. CATCH BASINS OR OTHER DRAINAGE DEVICES MUST BE USED TO INTERCEPT AND DIVERT THIS WATER.
3. EXISTING DITCH SECTIONS AND/OR CULVERTS SHALL BE MAINTAINED. SUB-STANDARD DITCH SECTIONS OR CULVERTS SHALL BE REPLACED AS DIRECTED BY THE CITY.
4. FOLLOW ADDITIONAL INSTRUCTIONS AS DIRECTED BY THE OPERATIONS AND MAINTENANCE SUPERVISOR AS STATED ON THE APPROVED PERMIT.
5. IF SIDE SEWER CLEANOUT RISER IS IN THE TRAVELLED AREA OF THE ROAD APPROACH, IT MUST HAVE A TRAFFIC ENCLOSURE.
6. THE CITY INSPECTOR SHALL INSPECT FORMS AND/OR SUB-GRADE PRIOR TO PAVING.
7. CULVERT SHALL BE SET AS DETERMINED BY THE CITY.
8. CRUSHED ROCK SHALL BE USED TO FILL AND SUPPORT THE EDGES OF THE DRIVEWAY AND ALL EXCESS CONCRETE SHALL BE REMOVED FROM THE RIGHT-OF-WAY.
9. CULVERT SHALL BE 12" MINIMUM DIAMETER.
10. CULVERT ENDS SHALL BE CUT TO A 3:1 INCLINED TAPER.

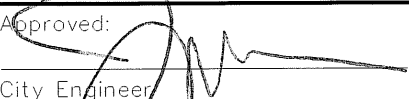
Approved:  2-14-06
 City Engineer Date



Dwg No: **S11**
ROAD APPROACH

STREET STANDARD DETAIL

CITY OF BONNEY LAKE RIGHT OF WAY REGULATIONS

I. PERMIT

Any person, firm, corporation, joint stock company, partnership, association or otherwise, whether of a private or governmental nature, and excepting therefrom only the city itself by its duly authorized agents or employees shall, prior to causing any excavation to be made over, along, under or across any street within the incorporated limits of the city as presently or hereafter constituted shall apply for a permit to do said excavation prior to the time of excavation, and shall supply to the appropriate agency of the city information sufficient to show the nature, purpose and location of the excavations. (Ord. 606A § 2, 1989). The City of Bonney Lake shall respond to each applicant within ten working days of application submittal.

A. The permittee shall use diligence in the execution of the work authorized under this permit in order not to endanger the public or unnecessarily obstruct travel along any road or right of way. Operations shall be so conducted as to permit safe and free travel over the roads and trailways at all times within the limits of the work herein prescribed. All safety measures for the free movement of traffic shall be provided by the permittee at his own cost. Permittee agrees to comply with all City Ordinances and regulations; Notify any utility or property owners subject to damage or inconvenience, 48 hours in advance, prior to commencement of the work, and permittee shall make all arrangements necessary for the protection of any such utility or owner interest; Execute the work with diligence and with due respect to all property, contracts, persons, rights and the interests and convenience to the public; Save the City harmless from any and all damages which may accrue to any person or property because of this installation or maintenance.

B. The installation shall be made in conformity with all applicable laws, regulations, and codes covering said installations. All installations shall be made in conformity with regulations of governmental agencies for the protection of the public.

C. These general provisions and specifications shall be considered as forming an integral part of each and every permit issued for operations within Bonney Lake. Installation, placement, location, and relocation of equipment and facilities shall comply with all federal, state, and local laws. The work authorized by this permit shall be done at such time and in such manner as shall be consistent with the safety of the public and shall conform to all requirements and standards of the City. If at any time it shall be found by the City that the work is not being or has not been properly performed, the permittee, upon being notified by the City, shall immediately take the necessary steps, at his own expense, to place the work in condition to conform to said requirements or standards.

II. FEES

The basic fees for a Right of Way / Road Approach permit shall be \$50.00 plus an additional amount, to cover inspection costs, calculated as follows:

A. For each street crossing excavation, \$1.00 per square foot of patch. Patch must extend 12 inches beyond the extent of trench. Permits for street crossings may only be issued where other methods have been tried and have been unsuccessful, or are deemed to be unsuitable by the public works director. Should such a permit be issued on-site inspection may be required during the backfilling and restoration process.

B. Permits for a push or boring will not require an additional fee. Permits for a push or boring will not require on-site inspection provided the excavation for the pit is at least five feet from the edge of pavement. Conversion of a permit from a push to an open cut will require submittal of an amended permit application, however the public works director may allow construction to proceed pending receipt of an amended permit application.

C. For any longitudinal excavation outside the pavement section, \$0.25 per lineal foot of trench. Longitudinal trenches outside the pavement and within two feet of the edge of pavement are allowed only by variance. Longitudinal trenches within two feet of the edge of pavement will require overlay of one-half of the street for the length of the close trench and 10 feet beyond on each end.

D. Longitudinal trenches within the pavement will be charged on the basis of \$1.00 per square foot of patch. Patches are measured 12 inches beyond the extent of the trench. Overlay of one-half the road width will be required. (Ord. 606A § 3, 1989).

III. BONDING AND INSURANCE

A street restoration bond is required for the protection of the city. The bond shall be for a minimum of \$5,000. If multiple projects are under construction at the same time the public works director may require higher bond amounts.

Contractors or utility owners working within the public right-of-way will carry liability insurance in an amount of at least \$1,000,000 and will provide the city with a certificate of insurance which names the city as a co-insured for all work they perform within the city’s right-of-way. Evidence of a credible self insurance program may be substituted for this insurance requirement provided that prior approval is given by the city. (Ord. 606A § 4, 1989).

IV. HOURS OF WORK

No work will be permitted on Saturday, Sunday or any holiday, or between the hours of 6:00 p.m. and 6:00 a.m. of any working day, except in case of emergency and then only upon notification of the city. (Ord. 606A § 6, 1989).

V. NOTIFICATION

The permit holder shall be responsible for the notification of all impacted parties 48 hours prior to start of construction and when construction is completed. The following will be notified as a minimum:

- A. Bonney Lake Police Department.....police@ci.bonney-lake.wa.us
- B. Bonney Lake Fire Department.....jmcdonald@eastpiercefire.org
- C. Sumner School District.....mark_baumgarten@sumner.wednet.edu
- D. United States Post Office.....kenn.linn@usps.gov
- E. Bonney Lake Public Works Department.....webert@ci.bonney-lake.wa.us
- F. Bonney Lake Engineering Department.....fondaa@ci.bonney-lake.wa.us

VI. RESERVATION OF CITY RIGHTS

The city reserves the right to order the change of location or the removal of any structure or structures authorized by permit or franchise at any time; said change or removal will be made at the sole expense of the party or parties to whom the permit is issued, or their successors and assigns.

All such changes, reconstruction or relocation by the grantees shall be done in such manner as will cause the least interference with any of the city’s work and the city shall in no wise be held liable for any damage to the grantee by reason of any such work by the city, its agents or representatives or by the exercise of any rights by the city upon the roads, streets, public places or structures in question.

The city may revoke, annul, change, amend, amplify, or terminate the permit issued or any of the conditions herein enumerated if grantee fails to comply with any or all of the provisions, requirements or regulations as herein set forth or through willful or unreasonable neglect, fails to heed or comply with notices given or if the utility is not installed or operated and maintained in conformity herewith or at all or for any cause or reason whatsoever. (Ord. 606A § 8, 1989).

VII. GRANTEE RESPONSIBILITIES - INDEMNIFICATION

A. By accepting a permit, the grantee, its successors or assigns, agrees to indemnify the city from and against claims made against the city for injuries or damages arising out of work performed by the grantee within the public right-of-way, but only to the extent that such claims are for injuries or such damages are caused by the negligence of grantee in the prosecution of such work. Any claim, from and against which the city intends to seek indemnity from the grantee, shall be submitted to grantee in writing and grantee shall have the right at its election and sole cost and expense to settle, compromise or defend such claim by attorneys of its own election. Grantee hereby waives its immunity from suit under RCW Title 51 if necessary to comply with this provision.

B. If the work done under the permit interferes in any way with the drainage of the city streets, or causes damage, the grantee shall wholly and at his own expense make such provisions as the public works director may direct to take care of said drainage and/or damage.

C. On completion of said work herein contemplated, all rubbish and debris shall be immediately removed and the roadway and roadside shall be left neat and presentable and satisfactory to the public works director.

D. Grantee shall comply with the Washington State Electrical Code, Washington State Department of Highways Standards and Standard Specifications for Road and Bridge Construction and all local codes, standards and ordinances.

E. The grantee recognizes and agrees that it is responsible for and will make at its own expense any changes that may be required in the location of work constructed under permits issued under these regulations.

F. The permit or privilege shall not be deemed or held to be an exclusive one and shall not prohibit the city from granting other permits or franchise rights of like or other nature to other public or private utilities, nor shall it prevent the city from using any of its roads, streets, or public places, or affect its right to full supervision and control over all or any part for them, none of which is hereby surrendered.

G. The party or parties to whom a permit is issued shall maintain at his or their sole expense the structure or object for which the permit is granted in a condition satisfactory to the public works director.

H. In accepting a permit, the grantee, his successors and assigns, agree that any damage or injury done to the property of the grantee or any expense incurred by him through the operation of a contractor, working for the city or of any city employee shall be at the sole expense of the grantee, his successors or assigns. (Ord. 606A § 9, 1989).

VIII. SAFETY / MAINTENANCE OF TRAFFIC

During the progress of the work, such barriers and warning signs shall be erected and maintained as may be necessary or as may be directed for the protection of the traveling public; the barriers shall be properly lighted when in place during hours of darkness and/or as required by the city.

At no time during construction will any roadway be entirely closed. One-way traffic shall be maintained at all times unless an approved, signed detour route is established. All traffic control shall comply with the M.U.T.C.D. All flag persons shall be qualified and shall have a flagger's card as issued by the Department of Labor and Industries on their person while performing the duties of a flagger. All flaggers shall wear the proper safety equipment as required by the Department of Labor and Industries. (Ord. 606A § 5, 1989).

A. All proposed detour plans must be approved by the City's engineering department and in writing 3 working days prior to commencement.

B. When a trail or roadway/ drive has been cut, appropriate signage must be kept in place and maintained until restoration is complete.

C. Excavations must be shored or sheeted, as required by O.S.H.A., when necessary to prevent under-mining of roadways, trailways, utilities, or for safety reasons. Stock piling of excavated material shall not occur within the public-right-of-way without proper traffic control.

D. Guys or stays shall not be attached to trees on right-of-way or private property nor obstruct roadways, sidewalks, trails, driveways, etc.

IX. OPERATIONS

A. All of the work herein contemplated shall be done under the supervision and to the satisfaction of the Public Works Director or his duly authorized agent or employee.

B. Existing Facilities – The utility facility and installations shall not interfere with any existing utility facility on the City’s right-of-way or easements. It is the responsibility of the applicant to call for timely, necessary locations of existing utilities. Call **ONE CALL** for locates two working days before you dig, drill, or blast. “It’s the law” 1-800-424-5555 (RCW 19.122).

C. Private Property – This permit as issued does not in any way imply an easement or right to enter private property.

D. Quality of Work – Finished surface, base and sub-base of all disturbed surfaces upon completion of work shall be to current design standards. New surfaces must match existing roads or trailways. Public right-of-way alignment and grade shall be maintained, unless otherwise authorized by the City. The surface shall be finished and restored within thirty (30) days upon completion of backfill.

E. Cutting Trees – The permission herein granted does not confer upon the permittee the right to cut, remove, or destroy trees or shrubbery within the legal limits of the right-of-way or easements that are not specifically identified on the plan attached to this permit or relieve permittee from obtaining any consent otherwise required from the owner of the property adjacent thereto. The permittee shall protect the root growth of significant trees and shrubbery within the public right-of-way adjacent thereto. The permittee shall comply with the City’s Tree Ordinance, if applicable.

F. Drainage – All waterways and overland drainage shall remain operative. Proper erosion control shall be established and maintained throughout the construction and restoration.

G. Driving Limitations:

1. Driving or parking on City trails or sidewalks shall only be permitted for those operations requiring direct access to the boulevard area where adequate shoulder width is not available. Vehicles within the right of way area shall utilize their warning flashers at all times.

2. Vehicles shall not be parked on trails or sidewalks in such a manner as to unnecessarily impede the safe and efficient use of trailways by the general public.

3. When City load limits are active, vehicles will not be permitted on trails and sidewalks.

H. Vehicles or equipment traversing roads or railway surfaces shall not utilize studded or chained tires, caterpillar traction, or any other form of traction that will result in damage to the surface.

I. Clean-Up – Street, trailways and affected right-of-way shall be cleaned at the end of each workday and cleaned after construction is completed and left in a neat and presentable condition. Any sediment or debris from improvement shall be removed from sanitary or storm sewer systems, including drainage swales and ponds, as needed.

J. Trees and Vegetation – Burning or discing operations and/or the use of chemicals to control or destroy trees, brush and other vegetation is prohibited without prior approval from the City.

K. Replacement of Sod – Wherever topsoil and sod are disturbed, they shall be replaced and maintained satisfactorily until the turf is established. Any turf that fails to be established shall be replaced and satisfactorily re-established. Restoration of boulevards shall include a minimum of 6” of topsoil or as approved by the City Engineer.

L. Sanitary Sewer and Water Services – Prior to any backfill of sanitary sewer and/or water services, the permittee shall have the workmanship inspected by the respective authority. Call Public Works Maintenance and Operations at 253-862-8602 X302 before performing water or sewer tap.

M. Proposed Location - Proposed utility location is to be identified on-site prior to permit issuance.

N. Permit on Job – Permits or copies (including approved detour plans) shall be kept on the work site while it is in progress and in the custody of the individual in charge, and shall be exhibited upon request made by any City official.

O. Conditions of permit - No person may excavate or obstruct the public right-of-way after the date specified in the permit, unless the person obtains a new permit or acquires a permit extension before the expiration of the original permit. The permit is valid only for the area of the public right-of-way specified in the permit; no permittee shall do any work outside the area specified in the permit, except as noted herein.

P. If the obstruction or excavation of the public right-of-way begins later or ends sooner than the dates specified in the permit, the permittee shall promptly notify the City Engineering Department.

Q. When possible, the permittee shall coordinate project work and installation of facilities in co-locations with other public right of way permits.

R. The permittee shall locate property lines abutting public right-of-ways and replace any destroyed property corners with the services of a State of Washington licensed surveyor.

X. STANDARDS

A. All final asphalt cuts will be made by saw cutting; wheel or jackhammer cuts will not be allowed unless the entire street is to be overlaid;

B. All backfill under asphalt paving and/or within four feet of the edge of pavement will be crushed rock meeting WSDOT's specification for crushed surfacing or other material deemed suitable by the public works director.

C. All backfill under asphalt paving will be placed in layers and each layer will be mechanically compacted using vibratory compactors capable of attaining the required compaction. Minimum compaction for all trenches under asphalt or within four feet of the edge of pavement will be 95 percent of the standard proctor density. Minimum density for all other areas within the public right-of-way shall be 90 percent of the standard proctor density. Inspection and/or testing if required by the city shall be at the sole expense of the permittee.

D. All buried pipelines, cable or wiring installed within the public right-of-way shall have at least 36 inches minimum cover unless written approval of the public works director is secured prior to actual construction.

E. All nonmetallic pipelines shall have 16 gauge minimum size copper locator wires buried with the pipe. Locator wires shall be brought to the surface at approximate 400-foot intervals to allow locators to connect to the locator wires. Connection to residential gas meters or telephone pedestals will serve to meet this requirement.

F. All utilities installed after the effective date of this chapter will be installed in conduit where they cross or lie under the traveled portion of the roadway or where they lie within two feet of the edge of pavement. Piping used as conduit shall be appropriately sized and shall be at least Schedule 40 PVC where other regulations do not exist and/or take precedence.

G. Temporary restoration of trenches shall be accomplished by using 4 inches of medium-curing (MC-250) liquid asphalt (cold mix) at the end of each working day. Under special circumstances and if approved by the City Engineer, steel plates suitable for H20 traffic loading conditions may be used. The plates shall be in good condition and placed with a cold mix "lip" to provide a smooth transition from the pavement to the steel plate. Materials, placement, and use of plates shall be as approved by the City Engineer or his/her authorized representative(s). Asphalt used for temporary restoration may

be dumped directly into the trench, bladed and rolled. After rolling, the trench must be filled flush to provide a smooth riding surface. All temporary patches shall be maintained by the contractor until such time as the permanent pavement patch is in place. Permittees or their contractors must make required repairs to trench patches within 24 hours when repairs are required to maintain the safety of the public roadway. Where permittees, their agents or employees fail to make repairs required by the city within 24 hours the city may cause the repairs to be made and the total cost of those repairs together with the city's overhead and attorney fees shall be borne by the permittee or the permittee's bonding company. No new permits will be issued and no work will be allowed on other existing permits while any person, company or entity is in default of any of the provisions of this chapter.

H. Trench restoration shall be either by a patch or patch plus overlay as required by the City.

1. All overlay, trench and pavement cuts shall be made by saw cuts. The cuts shall be a minimum of 10 feet outside the trench width and extend to the center of the road or as directed by the City.

2. All trenching shall be backfilled and streets shall be restored as shown in the standard details.

3. If multiple trench cuts (perpendicular to the direction of travel) are made in the same road and the cuts, as measured from the edge of the trench, are within 200 feet, then the road area in between the cuts shall also be overlaid to the widths specified by the City. In cases where a trench cut is made within 100 feet of an existing trench restoration, the road area between the existing trench restoration and the new trench shall be overlaid to the widths specified by the City.

4. When longitudinal trench cuts are made (parallel to the direction of travel), the roadway shall be overlaid to the widths as specified by the City.

5. When trenching within the roadway shoulder(s), the shoulder shall be restored in accordance with these standards.

6. Unless otherwise approved, the final patch shall be completed as soon as possible and shall be completed within 30 days after first opening the trench.

I. Overlays required by provisions of this chapter will be constructed of ACP meeting the WSDOT requirements for Class B ACP and will be at least 20 feet in length. (Ord. 606A § 10, 1989).

1. When utilizing trenchless installation methods to cross an area in which a City utility is located or when directed by the City, the permittee shall excavate an observation hole over the City utility to ensure damage does not occur during the work of the project.

2. If the project work involves open cut, the permittee shall install visual tracers at twelve (12) inches over buried facilities. If other construction methods are used, substitute location methods may be used upon approval by the City.

3. All facilities shall be located so as to not interfere with existing utilities & potential future right-of-way improvements, ie. sidewalks.

4. All above ground appurtenances shall be located no closer than ten (10) feet to hydrants, waterline valves, manholes, lift stations or catch basins unless approved by the City, and shall not be installed in front of or within visual sight lines of any City signs, monuments or amenities for facilities or parks. Minimum offsets from sidewalks and trails shall be 2 feet unless approved by the City.

5. Underground facilities shall not be installed between a hydrant and an auxiliary valve.

6. Underground facilities shall not be installed within five (5) feet of hydrants, waterline valves, lift stations, manholes or catch basins where utility easements exist beyond the roadway surface area of the public right-of-way and space is available therein. In those areas in which no utility easement exists, placement of an underground facility shall be between the edge of pavement and no closer than three (3) feet to an existing City utility appurtenance and any other utility, unless approved by the City.

7. In projects where an extensive effort to determine the location of City utilities lines will be required to determine the proper location and installation of private facilities, the permittee shall contact the City's Utility Representative at least two (2) weeks prior to the beginning of the work and shall cooperate to determine the location of the City utilities.

XI. PENALTIES

In the event that excavation is commenced without the excavator having applied for a permit prior to excavation, the public works director or his duly authorized agent or employee may cause said excavation to cease, the hole to be filled and the roadway surface repaired, even though said excavation is not complete. Except, that in those cases where emergency repairs are required, work may start immediately without prior approval from the city. Permits covering the emergency repairs shall be applied for as soon as the extent of the repair is determined. Any person, firm, corporation or otherwise who fails and refuses to comply with the terms of this chapter by failing or refusing to obtain a permit and pay the fees as herein set, shall be guilty of a misdemeanor. (Ord. 606A § 12, 1989).

XII. SUBMITTALS

These are minimum requirements and additional plans / details may be required where site conditions dictate. A site drawing and plans shall include the following:

- A. Site location, address, and names of adjacent or nearby streets
- B. North arrow
- C. Scale – 1”=20’ to 1”=50’
- D. Driveway entrances and details of plans to remove and replace asphalt or concrete in streets, driveways, and sidewalks
- E. Proposed scope of work being done in the right-of-way
- F. Profile reflecting underground utilities in the right-of-way
- G. Roadways
- H. Details of the location of all right-of-way lines and utility easements
- I. Distance of proposed utility location from right-of-way lines
- J. The proposed location and route of all Facilities to be constructed or installed and the applicant’s plan for right-of-way construction.
- K. Details of all existing City and non-City utilities and facilities in relationship to the applicant’s proposed route.
- L. Details of the materials the applicant proposes to install, such as pipe size, number of interducts, valves, etc.
- M. Details of any bores, trenches, handholes, manholes, switch gear, transformers, pedestals, etc. (including depth)
- N. The name, address, and phone numbers of the contractor or subcontractor who will perform the actual construction, including the name and telephone number of an individual with the contractor who will be available at all times during construction. Such information shall be required prior to the commencement of any work.
- O. A traffic control plan including proper barricading, traffic detours, work zones, signage, etc.